

The Matisse

Offered at \$309,900

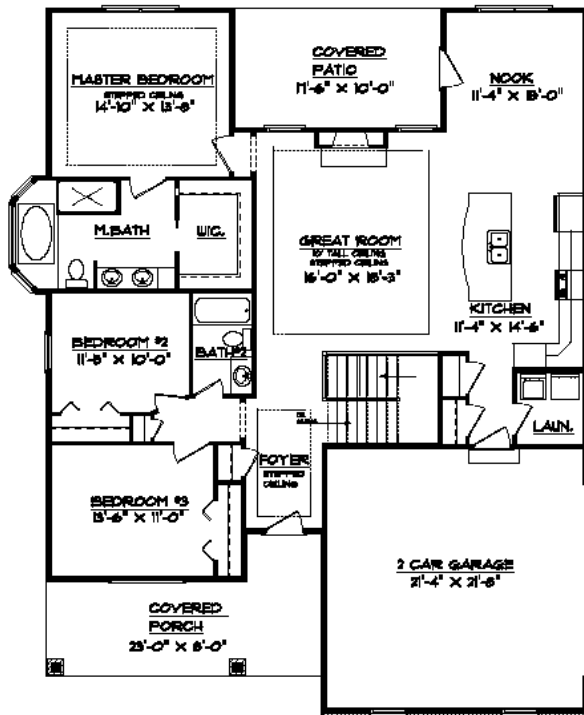

*Lot E251 Stone Creek
2746 E. Stone Creek Blvd.
Urbana, IL 61802*

Home Highlights

- Custom Ranch with Finished Basement
- 2644 Total Finished Square Feet
- 3 Bedrooms and 2 Baths on Main Floor
- 4th Bedroom, Full Bath, Wet bar and Rec. Room in Basement
- 9' Basement and 1st Floor Walls
- Open Floor Plan for Entertaining
- Large Kitchen Island
- Great Room with 10' Stepped Ceiling
- Master Suite with WIC, Whirlpool Tub, Custom Shower and Double Vanities

Plan Summary

First Floor	1752 sq.ft.
Finished Basement	892 sq.ft.
TOTAL Finished	2644 sq.ft.



**Building Relationships,
One Home at a Time.**



217-202-3336

Top 7th Internationally

DEVONSHIRE REALTY

StefaniePrattHomes.com

www.signaturehomes.ws



SIGNATURE HOMES
YOUR NAME IS WRITTEN ALL OVER IT

4120 Belmont Point. Champaign, IL 61822

Office: 217.355.1202 Fax: 217.355.3806

www.signaturehomes.ws